

APEX CABIN WORK AREA

- Bunk House
- Bunker Bed
- Office Cabin
- Porta Cabin
- Rest Room
- Store Room
- Conference Hall
- Executive Cabin
- Toilet And Bathroom
- Warehousing Cabinet

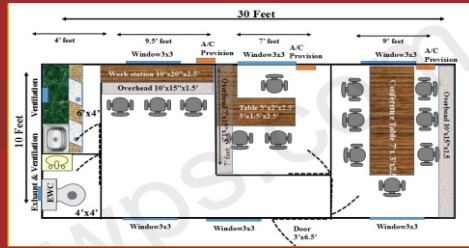

Office : Taximens Colony,
Naaz 7/A-34, BKC, LBS Marg,
Kurla (W), Mumbai - 400 070.

Mob. : 9594 999 588
Web : www.apexcabin.com
Email : sales@apexcabin.com

FACTORY ADDRESS.
Servey No.89, Adivali village,
Mumbra-Panvel Highway
Dist-Raigad-410210

OUR BRANCHE:

MUMBAI, AHMEDABAD, HYDERABAD, KOLKATA



The Spirit of the new office



2 We as Apex Portable Cabin take this opportunity to introduce ourselves as leading manufacturers and suppliers of quality and cost-effective portable cabins for Site Office, Godowns (Storage), ATM, Mess, Sanitary, Luxurious Cottages, Security Guard Cabins, Laboratory, Farm houses, Resorts, Industrial Projects, Film Studios, Re-locatable colonies, Drilling Camps, Business Stall, Shop etc.

These portable workstations are the ideal choice for those who are looking for crew cabins or mobile office. Our workstations are well furnished with world-class amenities. These are equipped with modern facilities to serve the very use of office environment. Our range of workstations have modular designed features combined with practical and well-furnished interiors ensure the highest levels of user satisfaction. These have well-built make to withstand critical temperature and weather conditions. **Apex Cabin** has been in business of manufacturing portable cabins since a decade. We have expanded our business by supplying quality portable cabins to our customers and have many successful commercial, industrial and residential projects completed across the country. Our portable cabins are best in quality with excellent aesthetics. We create exceptional value for our customers by understanding their needs and then providing the right quality products and services at the right time, every time.



Advantages of Portable / Mobile Cabin: Bu

Our Portable Cabin is essential for those customers who execute their work on different locations / sites. They can mount the cabin either in temporary or permanent basis and after execution of their projects / work they can dismantle the same without any destruction. Those companies who run number of projects in same time can use the container for Business Conference, staying for their executives or for also employer who can stay in luxurious style on site without paying any luxury charges.

Construction details of M.S. Portable Office Cabin (Lift & Shift type): This specification is only for newly fabricated cabins

3



Shell: The shell shall be fabricated from tested quality steel duly welded, comprising of base frame, peripheral structure, self draining roof, entry doors and of windows (as per requirement). The eight corners shall be sufficiently strengthened to facilitate transportation, lifting and placing.

Side and End Walls: The side and end frame shall be made out of pressed sections of suitable profiles/pillars of sufficient strength. Exterior wall shall be made up of 1.4 swg. MS specially corrugated sheet whereas 9 mm particle board will be used for interior walls. The steel sheet shall be treated for corrosion resistant. Panels shall be vertically corrugated, sheet shall be continuously welded to top side and base structure so as to offer better strength to weight ratio. All gaps will be sealed at edges and at seams, bottom etc to prevent ingress of moisture.

Base Frame: The base frame shall be made of pressed mild steel channel section. The main structural element shall be of 75 mm x 75mm and cross member shall be of 'C' channels section size 100 mm x 50 mm

Flooring Systems: On the bottom frame 18 mm thick plywood, bison panel/E board shall be fixed by means of self tapping screw. PVC vinyl flooring shall be fixed on the panel.



4



Double Decker Cabin

Best Quality Cabins

Roof: Self draining type roof shall be made out of 1.4 swg. M.S. sheet, adequate roof bows are to be provided. Roof shall be adequately cambered for draining of rain water. Interior paneling shall be done in 9 mm particle board with adequate insulation.

Main Entry Door: The door shall be of external opening type made out of the same material as wall panels with door closing unit. The construction of the door shall be double skin steel construction with 40 mm thick Rock wool insulation. The peripheral edges of the door shall be sealed with double gaskets to make it waterproof & leak proof. The door interior shall be finished with same material matching with that of the bunk house interior. The door shall be provided with locking arrangement with separate handles of both sides of the door as required. Main door will be insulated and fitted with Godrej mortise lock and power bolt.

Paint: Epoxy Zinc Phosphate primer & synthetic Epoxy paint for final 2 coats. (Corrosion free and fire proof paints)



Inner Paneling: The interior shall be aesthetically finished so as to give custom built appearance with extremely high quality workmanship. All vertically and horizontal corners shall be neatly and smoothly finished with Aluminum sections. The



Special Purpose Cabin

Best Quality Cabins

Insulation: 50 mm thick Rock wool insulation shall be used for walls and 50 mm thick Rock wool insulation to be provided for roof.



Aluminum Windows: Aluminum powder coated windows, sliding type shall be provided, made of aluminum section, 4 mm thick, clear vision glasses are to be fitted to it.



Electrical System: The bunk house will be provided with electrical wiring suitable for 250 volt, 50 HZ single phase AC power supply. All electrical wiring shall be concealed. Suitable copper cables shall be used for lighting circuits. The copper cables used will be of 2.5 mm cable for lighting circuits. ISI mark and concealed in PVC conduits insulated copper wire shall be used for wiring to be done in PVC conduit with small size distribution board with MCB protection and to separate with main supply.



6



Composite Panel Cabin



Interior Design



Exhibitions



Accommodation

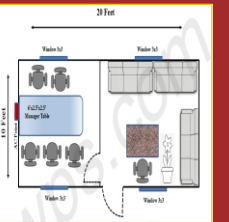

Layouts

We Think, We create, We deliver



It would be a pleasure to meet you to understand your requirements and to present to you what we have in offer. Please feel free to get in touch with us. You could also visit : www.apexcabin.com

At last we would like to mention herewith that we will provide you very prompt service and one call from your side is enough to fulfill your requirement and save your most important down time.

Regards,
Yours truly,

For Apex Portable Cabins

